

# Cora



## Show your food on a podium



A versatile showcase that has proven reliability and flexibility time and again.

Available in a variety of applications including Pastry, Deli, Chocolate and Gelato Ice cream with storage in linear and curved option. Comes with hydraulic lift up glass, chrome covered pistons and Pyrolytic heated glass to prevent fogging. LED lighting is standard.



*Discover the Art of Display...*

# *Cora* Gelato



Unfinished front & sides  
for custom finish



361-367 Beach Road, Burlingame, CA 94010  
Tel: 855.885.2400 | 650.342.2400 | Fax: 650.342.7400  
sales@oscartek.com | www.oscartek.com

# *Cora*

## Deli/Pastry/Chocolate/Neutral



361-367 Beach Road, Burlingame, CA 94010  
Tel: 855.885.2400 | 650.342.2400 | Fax: 650.342.7400  
sales@oscartek.com | www.oscartek.com

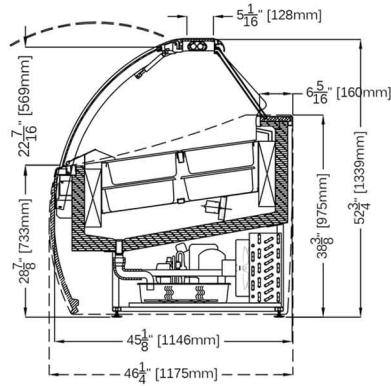

### STANDARD FEATURES

- Chrome finishing
- Semi-hermetic compressor
- Pistons assisted front glass opening system
- LED lighting
- Cases ship standard unfinished

### OPTIONS

- Flat or round front/side panels
- Remote condensing unit
- Stainless steel or acrylic pans
- Round tubs
- RAL color/laminate front and side panels
- Popsicle display tray (stainless steel & plastic. Plastic available in color options (see images below)
- Casters

### Round Tubs Layouts (optional):

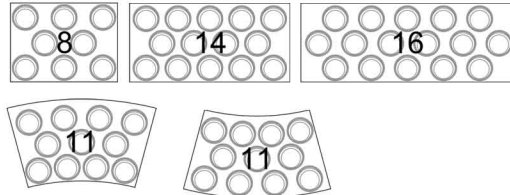

### 30° Open (5 Liter)

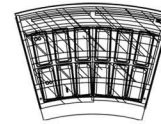

### 30° Open (8.5 Liter)

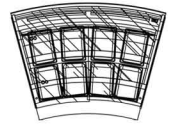

### 30° Closed (5 Liter)

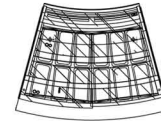

### 30° Closed (8.5 Liter)

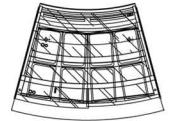

CORA GELATO							
TECHNICAL FEATURES		MODELS					
		CORA G1110	CORA G1610	CORA G2106	CORA G2106 DUAL TEMP	CORA GA30	CORA GC30
External Dimensions (L-D-H)	Inches	*43 11/16 - 45 1/8" - 52 3/4"	*63 3/8" - 45 1/8" - 52 3/4"	*82 15/16" - 45 1/8" - 52 3/4"	*82 15/16" - 45 1/8" - 52 3/4"	*63 1/4" - 45 1/8" - 52 3/4"	*38 5/8" - 45 1/8" - 52 3/4"
	MM	*1110 - 1146 - 1339	*1610 - 1146 - 1339	*2106 - 1146 - 1339	*2106 - 1146 - 1339	*1607 - 1146 - 1339	*981 - 1146 - 1339
Crated Dimensions (L-D-H)	Inches	50 1/8" - 53 1/8" - 63"	70 7/8" - 53 1/8" - 63"	89 1/2" - 53 1/8" - 63"	89 1/2" - 53 1/8" - 63"	70" - 53 1/8" - 63"	45" - 53 1/8" - 63"
	MM	1273 - 1350 - 1600	1800 - 1350 - 1600	2273 - 1350 - 1600	2273 - 1350 - 1600	1778 - 1350 - 1600	1143 - 1350 - 1600
5 Liter Pan Capacity** 14 3/16" x 6 1/2" x 4 3/4" (360mm x 165mm x 120mm)	Pan Configuration						
8 Liter Pan Capacity** 14 3/16" x 9 13/16" x 4 3/4" (360mm x 250mm x 120mm)	Pan Configuration						
Refrigeration	Type	Fan Ventilated	Fan Ventilated	Fan Ventilated	Fan Ventilated	Fan Ventilated	Fan Ventilated
Refrigeration Display Area	Type	Deck	Deck	Deck	Deck	Deck	Deck
Operating Temperature	°C / °F	-18°C / -0.4°F	-18°C / -0.4°F	-18°C / -0.4°F	(2) -18°C / -0.4°F	-18°C / -0.4°F	-18°C / -0.4°F
Compressor	Nr./Type	1 / Semi-Hermetic	1 / Semi-Hermetic	1 / Semi-Hermetic	2 / Semi-Hermetic	1 / Semi-Hermetic	1 / Semi-Hermetic
BTU'S @ -25°F Evap Temperature	BTU'S	2450 BTU'S 400/3/50 (EU)	3580 BTU'S 400/3/50 (EU)	4550 BTU'S 400/3/50 (EU)	11,840 BTU'S 400/3/50 (EU)	3610 BTU'S 400/3/50 (EU)	3610 BTU'S 400/3/50 (EU)
Electric Supply	(V/Ph/Hz)	208-220/3/60Hz (USA)	208-220/3/60Hz (USA)	208-220/3/60Hz (USA)	208-220/3/60Hz (USA)	208-220/3/60Hz (USA)	208-220/3/60Hz (USA)
Power Consumption	(W/A)	1950W / 5.2A	3030W / 8.4A	3620W / 9.4A	3700W / 9.5A	2820W / 7.2A	2780W / 6.9A
Defrost	Mode/Type	Reverse Cycle	Reverse Cycle	Reverse Cycle	Reverse Cycle	Reverse Cycle	Reverse Cycle
Climatic Class	N°°C/F°/H.R.	4+ / 35/95/70%	4+ / 35/95/70%	4+ / 35/95/70%	4+ / 35/95/70%	4+ / 35/95/70%	4+ / 35/95/70%
Refrigerant Gas	Type	R452A	R452A	R452A	R452A	R452A	R452A
Net Weights	Kg/Lb	254Kgs / 560Lbs	323Kgs / 712Lbs	360Kgs / 793Lbs	410Kgs / 903Lbs	295Kgs / 650Lbs	295Kgs / 650Lbs
Crated Weights	Kg/Lb	364Kgs / 802Lbs	473Kgs / 1042Lbs	560Kgs / 1234Lbs	610Kgs / 1344Lbs	455Kgs / 1444Lbs	455Kgs / 1444Lbs

\* DIMENSIONS ARE WITHOUT SIDE PANELS    \*\* PANS NOT INCLUDED



361-367 Beach Road, Burlingame, CA 94010  
 Tel: 855.885.2400 | 650.342.2400 | Fax: 650.342.7400  
 sales@oscartek.com | www.oscartek.com



## DELI/PASTRY WITHOUT DRAWERS

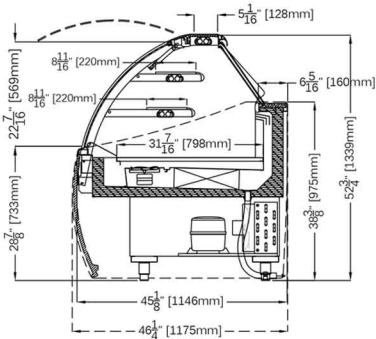

## DELI/PASTRY WITH DRAWERS

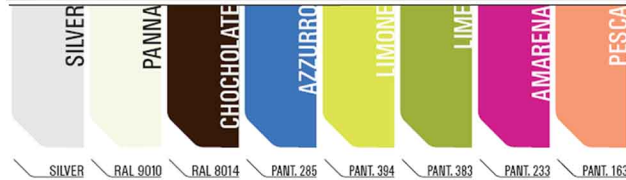
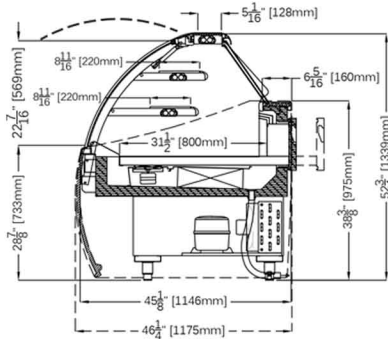

## STANDARD FEATURES

- Top shelf non-refrigerated
- Refrigerated lower shelf + deck
- LED lighting on each shelf
- Automatic electric defrost
- Cases ship standard unfinished

## OPTIONS

- Flat or round front/side panels
- Remote condensing unit
- Condensate water tray with electric evaporation
- RAL color/laminate front and side panels
- Casters

## 30° Open

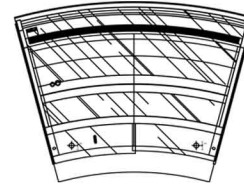

## 30° Closed

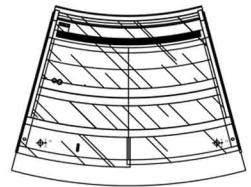

CORA DELI/PASTRY						
TECHNICAL FEATURES		MODELS				
		CORA DP1110	CORA DP1610	CORA DP2106	CORA DPA30	CORA DPC30
External Dimensions (L-D-H)	Inches	*43 11/16 - 45 1/8" - 52 3/4"	*63 3/8" - 45 1/8" - 52 3/4"	*82 15/16" - 45 1/8" - 52 3/4"	*63 1/4" - 45 1/8" - 52 3/4"	*38 5/8" - 45 1/8" - 52 3/4"
	MM	*1110 - 1146 - 1339	*1610 - 1146 - 1339	*2106 - 1146 - 1339	*1607 - 1146 - 1339	*981 - 1146 - 1339
Crated Dimensions (L-D-H)	Inches	50 1/8" - 53 1/8" - 63"	70 7/8" - 53 1/8" - 63"	89 1/2" - 53 1/8" - 63"	70" - 53 1/8" - 63"	45" - 53 1/8" - 63"
	MM	1273 - 1350 - 1600	1800 - 1350 - 1600	2273 - 1350 - 1600	1778 - 1350 - 1600	1143 - 1350 - 1600
Refrigeration	Type	Fan Ventilated	Fan Ventilated	Fan Ventilated	Fan Ventilated	Fan Ventilated
Refrigeration Display Area	Type	Deck + Lower Shelf	Deck + Lower Shelf	Deck + Lower Shelf	Deck + Lower Shelf	Deck + Lower Shelf
Operating Temperature	°C / °F	+4°C / 39°F	+4°C / 39°F	+4°C / 39°F	+4°C / 39°F	+4°C / 39°F
Compressor	Nr./Type	1 / Hermetic	1 / Hermetic	1 / Hermetic	1 / Hermetic	1 / Hermetic
BTU'S @ +14°F Evap Temperature	BTU'S	3200 BTU'S	3840 BTU'S	4480 BTU'S	3840 BTU'S	3840 BTU'S
		230/1/50 (EU)	230/1/50 (EU)	230/1/50 (EU)	230/1/50 (EU)	230/1/50 (EU)
		120/1/60 (USA)	120/1/60 (USA)	120/1/60 (USA)	120/1/60 (USA)	120/1/60 (USA)
Electric Supply	(V/Ph/Hz)	120/1/60 (USA)	120/1/60 (USA)	120/1/60 (USA)	120/1/60 (USA)	120/1/60 (USA)
Power Consumption	(W/A)	1085W / 8.2A	1190W / 8A	1490W / 9A	1170W / 8A	1140W / 8A
Defrost	Mode/Type	Electric	Electric	Electric	Electric	Electric
Climatic Class	N°/°C/F°/H.R.	4+/35/95/70%	4+/35/95/70%	4+/35/95/70%	4+/35/95/70%	4+/35/95/70%
Refrigerant Gas	Type	R452A	R452A	R452A	R452A	R452A
Net Weights	Kg/Lb	205Kgs / 650Lbs	275Kgs / 606Lbs	340Kgs / 749Lbs	250Kgs / 551Lbs	250Kgs / 551Lbs
Crated Weights	Kg/Lb	315Kgs / 694Lbs	425Kgs / 936Lbs	530Kgs / 1168Lbs	400Kgs / 881Lbs	400Kgs / 881Lbs

\* DIMENSIONS ARE WITHOUT SIDE PANELS

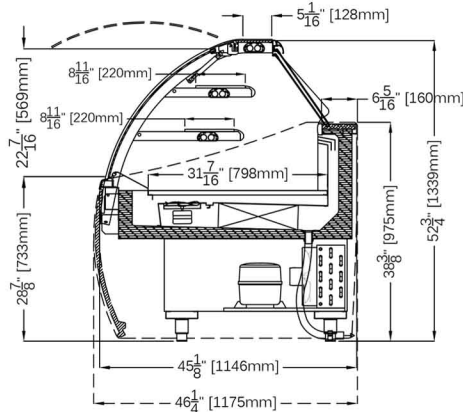

## STANDARD FEATURES

- Top shelf non-refrigerated
- Refrigerated lower shelf + deck
- LED lighting on each shelf
- Automatic electric defrost
- Humidity control
- Cases ship standard unfinished

## OPTIONS

- Flat or round front/side panels
- Remote condensing unit
- Condensate water tray with electric evaporation
- RAL color/laminate front and side panels
- Casters

## 30° Open

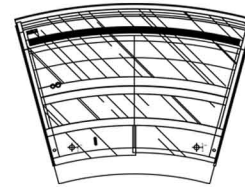

## 30° Closed

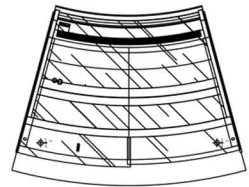

CORA CHOCOLATE						
TECHNICAL FEATURES		MODELS				
		CORA C1110	CORA C1610	CORA C2106	CORA CA30	CORA CC30
External Dimensions (L-D-H)	Inches	*43 11/16 - 45 1/8" - 52 3/4"	*63 3/8" - 45 1/8" - 52 3/4"	*82 15/16" - 45 1/8" - 52 3/4"	*63 1/4" - 45 1/8" - 52 3/4"	*38 5/8" - 45 1/8" - 52 3/4"
	Inches-MM	*1110 - 1146 - 1339	*1610 - 1146 - 1339	*2106 - 1146 - 1339	*1607 - 1146 - 1339	*981 - 1146 - 1339
Crated Dimensions (L-D-H)	Inches	50 1/8" - 53 1/8" - 63"	70 7/8" - 53 1/8" - 63"	89 1/2" - 53 1/8" - 63"	70" - 53 1/8" - 63"	45" - 53 1/8" - 63"
	Inches-MM	1273 - 1350 - 1600	1800 - 1350 - 1600	2273 - 1350 - 1600	1778 - 1350 - 1600	1143 - 1350 - 1600
Humidity Control	Type	35-70%	35-70%	35-70%	35-70%	35-70%
Refrigeration Display Area	Type	Deck + Lower Shelf	Deck + Lower Shelf	Deck + Lower Shelf	Deck + Lower Shelf	Deck + Lower Shelf
Operating Temperature	°C / °F	14°C / 58°F	14°C / 58°F	14°C / 58°F	14°C / 58°F	14°C / 58°F
Compressor	Nr./Type	1 / Hermetic	1 / Hermetic	1 / Hermetic	1 / Hermetic	1 / Hermetic
BTU'S @ +35°F Evap Temperature	BTU'S	3200 BTU'S	3840 BTU'S	4480 BTU'S	3840 BTU'S	3840 BTU'S
Electric Supply	(V/Ph/Hz)	230/1/50 (UE) 208-220/1/60 (USA)	230/1/50 (UE) 208-220/1/60 (USA)	230/1/50 (UE) 208-220/1/60 (USA)	230/1/50 (UE) 208-220/1/60 (USA)	230/1/50 (UE) 208-220/1/60 (USA)
Power Consumption	(W/A)	1085W / 8.2A	1190W / 8A	1490W / 9A	1170W / 8A	1140W / 8A
Defrost	Mode/Type	Electric	Electric	Electric	Electric	Electric
Climatic Class	N°/°C/F°/H.R.	4+/35/95/70%	4+/35/95/70%	4+/35/95/70%	4+/35/95/70%	4+/35/95/70%
Refrigerant Gas	Type	R452A	R452A	R452A	R452A	R452A
Net Weights	Kg/Lb	205Kgs / 650Lbs	275Kgs / 606Lbs	340Kgs / 749Lbs	250Kgs / 551Lbs	250Kgs / 551Lbs
Crated Weights	Kg/Lb	315Kgs / 694Lbs	425Kgs / 936Lbs	530Kgs / 1168Lbs	400Kgs / 881Lbs	400Kgs / 881Lbs

\* DIMENSIONS ARE WITHOUT SIDE PANELS

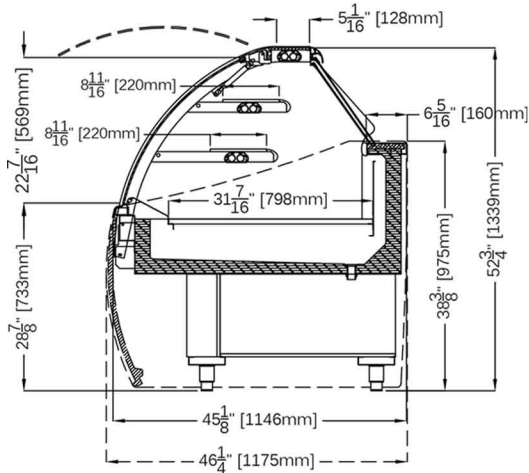

## STANDARD FEATURES

- Dry case
- LED lighting on each shelf
- Cases ship standard unfinished

## OPTIONS

- Flat or round front/side panels
- RAL color/laminate front and side panels
- Casters

## 30° Open

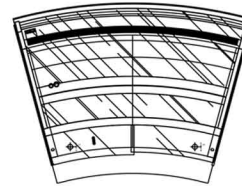

## 30° Closed

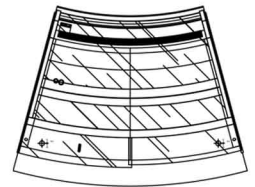

CORA NEUTRAL						
TECHNICAL FEATURES		MODELS				
		CORA N1110	CORA N1610	CORA N2106	CORA NA30	CORA NC30
External Dimensions (L-D-H)	Inches	*43 11/16 - 45 1/8" - 52 3/4"	*63 3/8" - 45 1/8" - 52 3/4"	*82 15/16" - 45 1/8" - 52 3/4"	*63 1/4" - 45 1/8" - 52 3/4"	*38 5/8" - 45 1/8" - 52 3/4"
	Inches-MM	*1110 - 1146 - 1339	*1610 - 1146 - 1339	*2106 - 1146 - 1339	*1607 - 1146 - 1339	*981 - 1146 - 1339
Crated Dimensions (L-D-H)	Inches	50 1/8" - 53 1/8" - 63"	70 7/8" - 53 1/8" - 63"	89 1/2" - 53 1/8" - 63"	70" - 53 1/8" - 63"	45" - 53 1/8" - 63"
	Inches-MM	1273 - 1350 - 1600	1800 - 1350 - 1600	2273 - 1350 - 1600	1778 - 1350 - 1600	1143 - 1350 - 1600
Power Supply	(V)	120V	120V	120V	120V	120V
Amperage	(A)	2A	3A	4A	2A	2A
Operating Temperature	°C / °F	Ambient	Ambient	Ambient	Ambient	Ambient
Net Weights	Kg/Lb	94Kgs / 216Lbs	118Kgs / 271Lbs	130Kgs / 299Lbs	118Kgs / 271Lbs	118Kgs / 271Lbs
Crated Weights	Kg/Lb	110Kgs / 253Lbs	138Kgs / 318Lbs	155Kgs / 356Lbs	138Kgs / 318Lbs	138Kgs / 318Lbs

\* DIMENSIONS ARE WITHOUT SIDE PANELS

## CS (DRY)

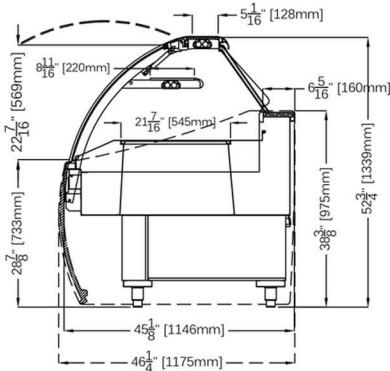

## CBM (BAIN MARIE)

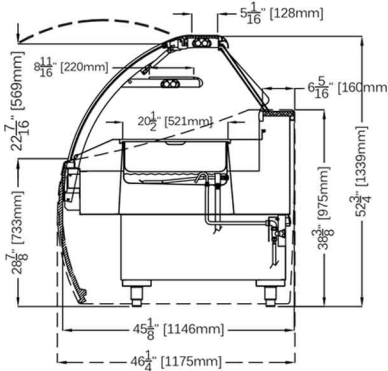

### STANDARD FEATURE

- LED lighting on each shelf
- CS: dry warm top on stainless steel basin
- CBM: hot well food warmer
- Cases ship standard unfinished

### OPTIONS

- Flat or round front/side panels
- Heated glass shelf with digital control
- RAL color/laminate front and side panels
- Casters

### CBM (BAIN MARIE) LAYOUTS:

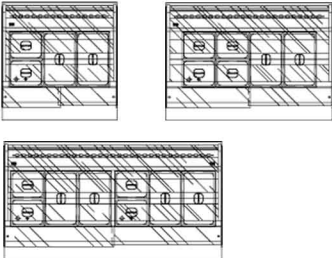

		CORA HOT (CS-DRY)		
TECHNICAL FEATURES		CORA CS-DRY		
		CORA CS1110	CORA CS1610	CORA CS2106
External Dimensions (L-D-H)	Inches	*43 11/16 - 45 1/8" - 52 3/4"	*63 3/8" - 45 1/8" - 52 3/4"	*82 15/16" - 45 1/8" - 52 3/4"
	Inches-MM	*1110 - 1146 - 1339	*1610 - 1146 - 1339	*2106 - 1146 - 1339
Crated Dimensions (L-D-H)	Inches	50 1/8" - 53 1/8" - 63"	70 7/8" - 53 1/8" - 63"	89 1/2" - 53 1/8" - 63"
	Inches-MM	1273 - 1350 - 1600	1800 - 1350 - 1600	2273 - 1350 - 1600
Power Supply**	(V/PH/HZ)	208-220V/1Ph/60Hz (2)	208-220V/1Ph/60Hz (2)	208-220V/1Ph/60Hz (2)
Power Amps	HEAT LAMP (V/A)	208-220V/2.5A	208-220V/3.5A	208-220V/4A
Direct Connection**	HOT PLATE (V/A)	120V/6.7A - NEMA 5-15P	120V/9.3A - NEMA 5-15P	120V/12A - NEMA 5-15P
Operating Temperature	°C / °F	80°C / 177°F	80°C / 177°F	80°C / 177°F
Net Weights	Kg/Lb	104Kgs / 239Lbs	144Kgs / 331Lbs	188Kgs / 432Lbs
Crated Weights	Kg/Lb	124Kgs / 285Lbs	170Kgs / 391Lbs	205Kgs / 470Lbs

\* DIMENSIONS ARE WITHOUT SIDE PANELS \*\* REQUIRES 2 INDEPENDENT POWER SUPPLY

		CORA HOT (CBM-BAIN MARIE)		
TECHNICAL FEATURES		CORA CBM-BAIN MARIE		
		CORA CBM1110	CORA CBM1610	CORA CBM2106
External Dimensions (L-D-H)	Inches	*43 11/16 - 45 1/8" - 52 3/4"	*63 3/8" - 45 1/8" - 52 3/4"	*82 15/16" - 45 1/8" - 52 3/4"
	Inches-MM	*1110 - 1146 - 1339	*1610 - 1146 - 1339	*2106 - 1146 - 1339
Crated Dimensions (L-D-H)	Inches	50 1/8" - 53 1/8" - 63"	70 7/8" - 53 1/8" - 63"	89 1/2" - 53 1/8" - 63"
	Inches-MM	1273 - 1350 - 1600	1800 - 1350 - 1600	2273 - 1350 - 1600
Power Supply**	(V/PH/HZ)	208-220V/1Ph/60Hz (2)	208-220V/1Ph/60Hz (2)	208-220V/1Ph/60Hz (2)
Power Amps	HEAT LAMP (V/A)	208-220V/2.5A	208-220V/3.5A	208-220V/4A
Direct Connection**	BAIN MARIE (V/A)	208-220V/11.6 A	208-220V/17.4A	208-220V/20.1A
Operating Temperature	°C / °F	80°C / 177°F	80°C / 177°F	80°C / 177°F
Net Weights	Kg/Lb	104Kgs / 239Lbs	144Kgs / 331Lbs	188Kgs / 432Lbs
Crated Weights	Kg/Lb	124Kgs / 285Lbs	170Kgs / 391Lbs	205Kgs / 470Lbs

\* DIMENSIONS ARE WITHOUT SIDE PANELS \*\* REQUIRES 2 INDEPENDENT POWER SUPPLY

NOTE: CBM-BAIN MARIE: DRAIN SIZE FOR INDIVIDUAL WELL 3/4"

## STANDARD FEATURES

- Double panel side glasses
- LED lighting on each shelf
- Dixell digital control
- Self contained
- Remote (model A90X only)
- Stainless steel foam in place bottom and top
- Adjustable feet
- Cases ship standard unfinished

## OPTIONS

- Model A90X - self contained
- Stainless steel side panels in lieu of glass
- Roll down locking shutter
- Epoxy RAL color interior
- Remote air cooled or water cooled
- RAL color/laminate front and side panels
- Condensate pan
- Casters



CORA GRAB AND GO					
TECHNICAL FEATURES		MODELS			
		CORA GNG 1000	CORA GNG 1300	CORA GNG 1500	CORA GNG 1700
External Dimensions (L-D-H)	Inches	39 3/8" - 45 1/8" - 52 3/4"	51 3/16" - 45 1/8" - 52 3/4"	59 1/16" - 45 1/8" - 52 3/4"	66 15/16" - 45 1/8" - 52 3/4"
	Inches-MM	1000 - 1146 - 1339	1300 - 1146 - 1339	1500 - 1146 - 1339	1700 - 1146 - 1339
Crated Dimensions (L-D-H)	Inches	46" - 53 1/8" - 63"	57" - 53 1/8" - 63"	66" - 53 1/8" - 63"	73" - 53 1/8" - 63"
	Inches-MM	1168 - 1350 - 1600	1447 - 1350 - 1600	1676 - 1350 - 1600	1854 - 1350 - 1600
BTU's @ +14°F Evap Temperature	BTU'S	4200 BTU'S	6222 BTU'S	6720 BTU'S	7225 BTU'S
Power Supply	(V/Ph/Hz)	220/1/60	220/1/60	220/1/60	220/1/60
Amperage	(A)	8A	9A	12A	15A
Operating Temperature	°F	+15°F	+15°F	+15°F	+15°F
Net Weights	Kg/Lb	130Kgs / 286Lbs	200Kgs / 440Lbs	240Kgs / 528Lbs	279Kgs / 616Lbs
Crated Weights	Kg/Lb	145Kgs / 319Lbs	220Kgs / 484Lbs	255Kgs / 561Lbs	289Kgs / 638Lbs

\* DIMENSIONS ARE WITHOUT SIDE PANELS \* REMOTE APPLICATION - CONDENSING UNIT SOLD SEPERATELY \* FLOOR SINK RECOMMENDED ON THESE MODELS

CORA GRAB AND GO					
TECHNICAL FEATURES		MODELS			
		CORA GNG 2000	CORA GNG A30	CORA GNG A90	CORA GNG A90X
External Dimensions (L-D-H)	Inches	78 3/4" - 45 1/8" - 52 3/4"	64 11/16" - 45 1/8" - 52 3/4"	65" - 45 1/8" - 52 3/4"	70 13/16" - 45 1/8" - 34 5/8"
	Inches-MM	2000 - 1146 - 1339	1643 - 1146 - 1339	1650 - 1146 - 1339	1798 - 1146 - 879
Crated Dimensions (L-D-H)	Inches	84" - 53 1/8" - 63"	70" - 53 1/8" - 63"	70" - 53 1/8" - 63"	77" - 53 1/8" - 41"
	Inches-MM	2133 - 1350 - 1600	1778 - 1350 - 1600	1778 - 1350 - 1600	1955 - 1350 - 1041
BTU's @ +14°F Evap Temperature	BTU'S	8820 BTU'S	6720 BTU'S	8950 BTU'S	12,600 BTU'S
Power Supply	(V/Ph/Hz)	220/1/60	220/1/60	220/1/60	220/1/60
Amperage	(A)	16A	15A	17A	2A
Operating Temperature	°F	+15°F	+15°F	+15°F	+15°F
Net Weights	Kg/Lb	300Kgs / 660Lbs	240Kgs / 528Lbs	300Kgs / 660Lbs	344Kgs / 760Lbs
Crated Weights	Kg/Lb	330Kgs / 726Lbs	255Kgs / 561Lbs	330Kgs / 726Lbs	374Kgs / 826Lbs

\* DIMENSIONS ARE WITHOUT SIDE PANELS \* REMOTE APPLICATION - CONDENSING UNIT SOLD SEPERATELY \* FLOOR SINK RECOMMENDED ON THESE MODELS

\* Manufacturer reserves the right to change specifications without notice. Not responsible for error and omissions.



361-367 Beach Road, Burlingame, CA 94010  
 Tel: 855.885.2400 | 650.342.2400 | Fax: 650.342.7400  
 sales@oscartek.com | www.oscartek.com





# CORA GNG

# Grab and Go Showcase

## FRONT ELEVATIONS (CUSTOMER SIDE):

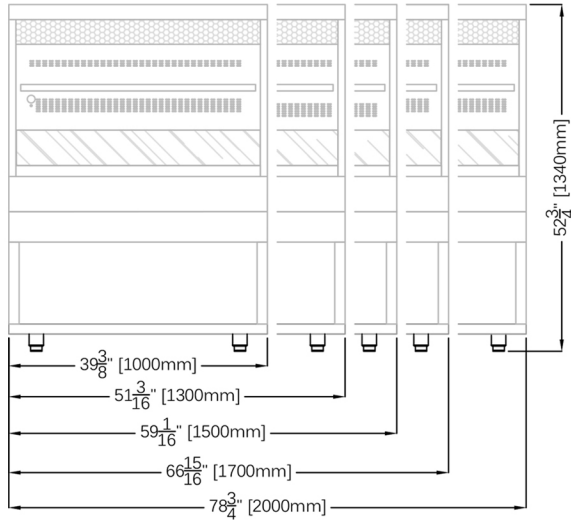

## GNG A30

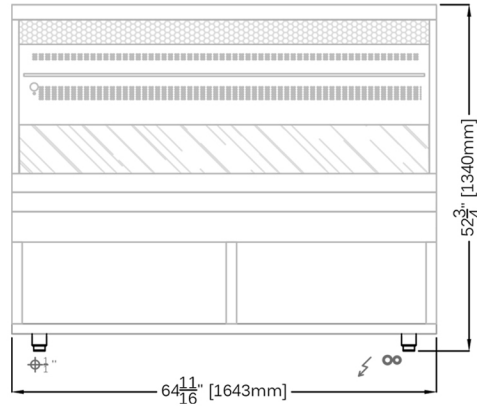

## SECTION A-A GNG A90

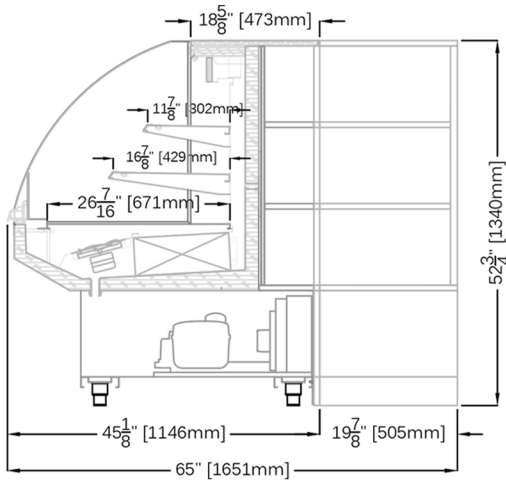

## SECTION A-A GNG A90X

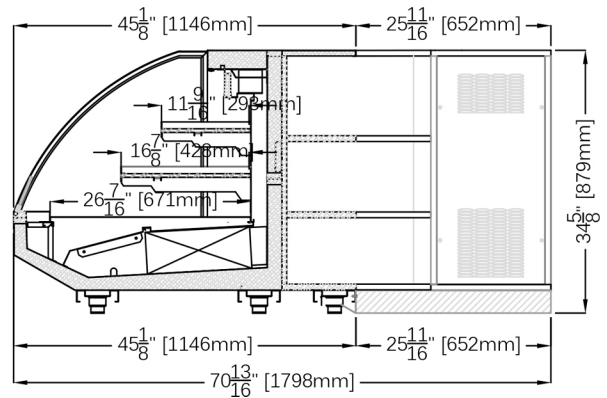

## FRONT ELEVATION (CUSTOMER SIDE) GNG A90X

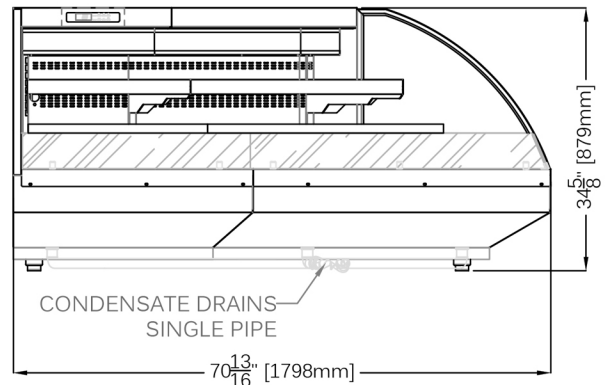

\* Manufacturer reserves the right to change specifications without notice. Not responsible for error and omissions.



361-367 Beach Road, Burlingame, CA 94010  
 Tel: 855.885.2400 | 650.342.2400 | Fax: 650.342.7400  
 sales@oscartek.com | www.oscartek.com

